

**GAS WIRELESS CONTROLS PRODUCT OVERVIEW**

**ON/OFF CONTROLLER CONNECTIONS**

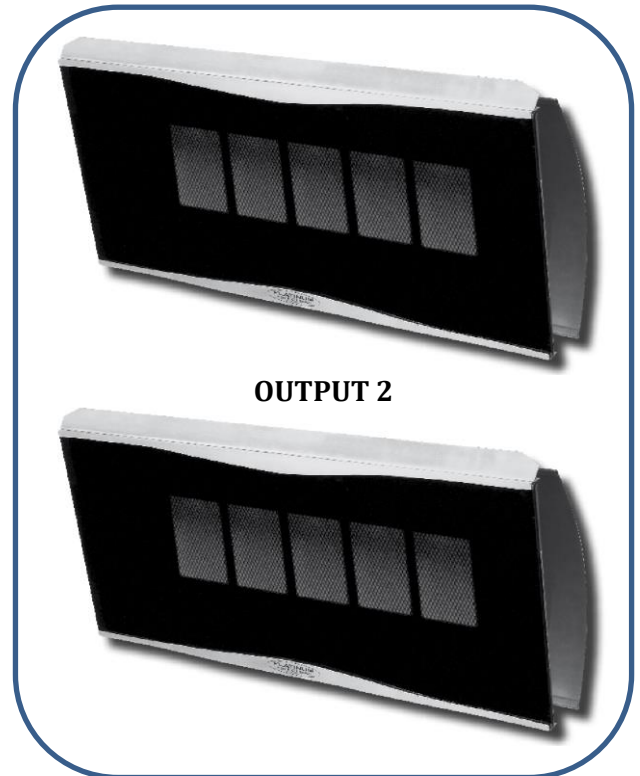
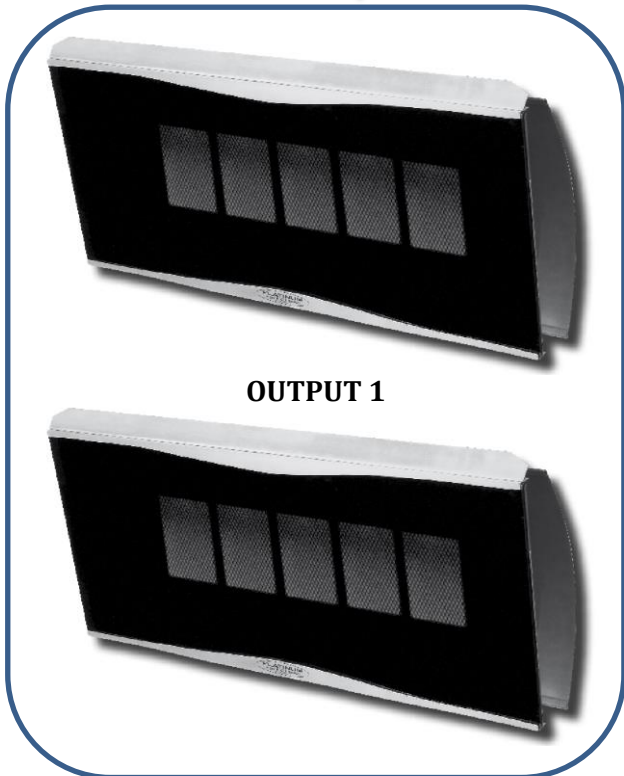
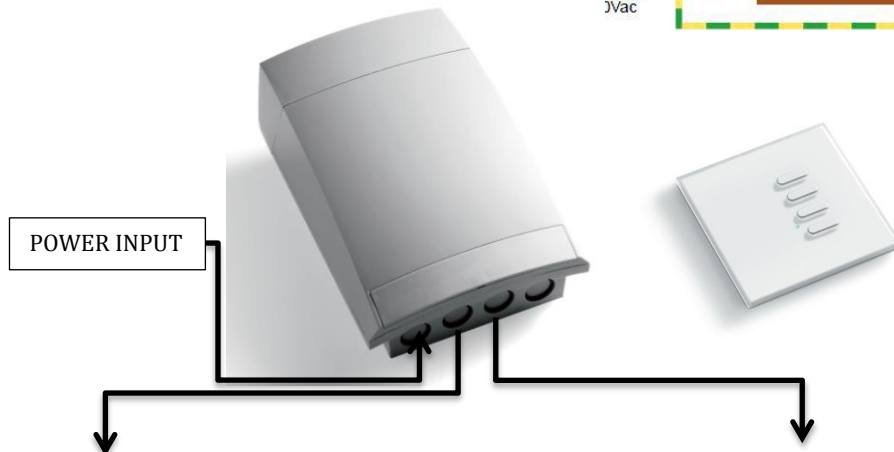
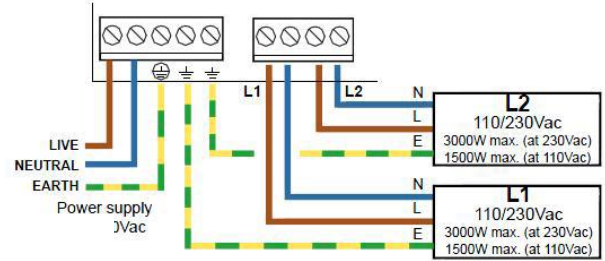

**INSTALLATION:**  
 -1 cable connection per output ONLY  
 -Parallel connection per output to be made outside the ON/OFF box

**NOTES:**  
 -2 gas heaters MAX per output  
 -Low amperage power supply acceptable (10A)

## GAS WIRELESS CONTROLS PRODUCT OVERVIEW

---

### ON/OFF REMOTE OPTIONS

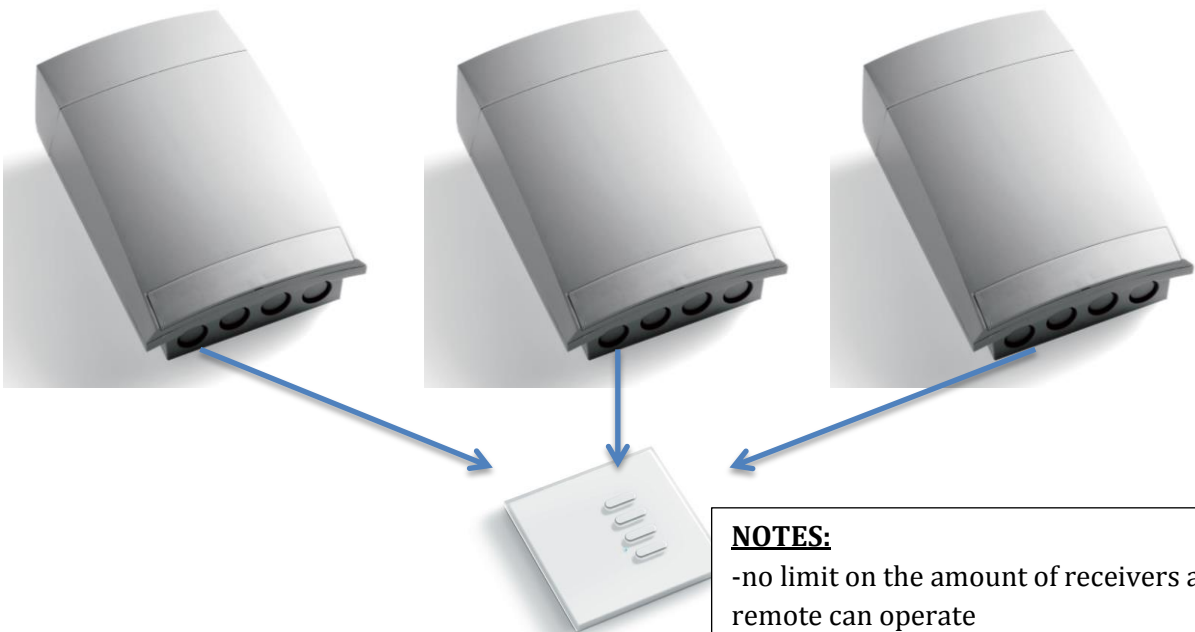
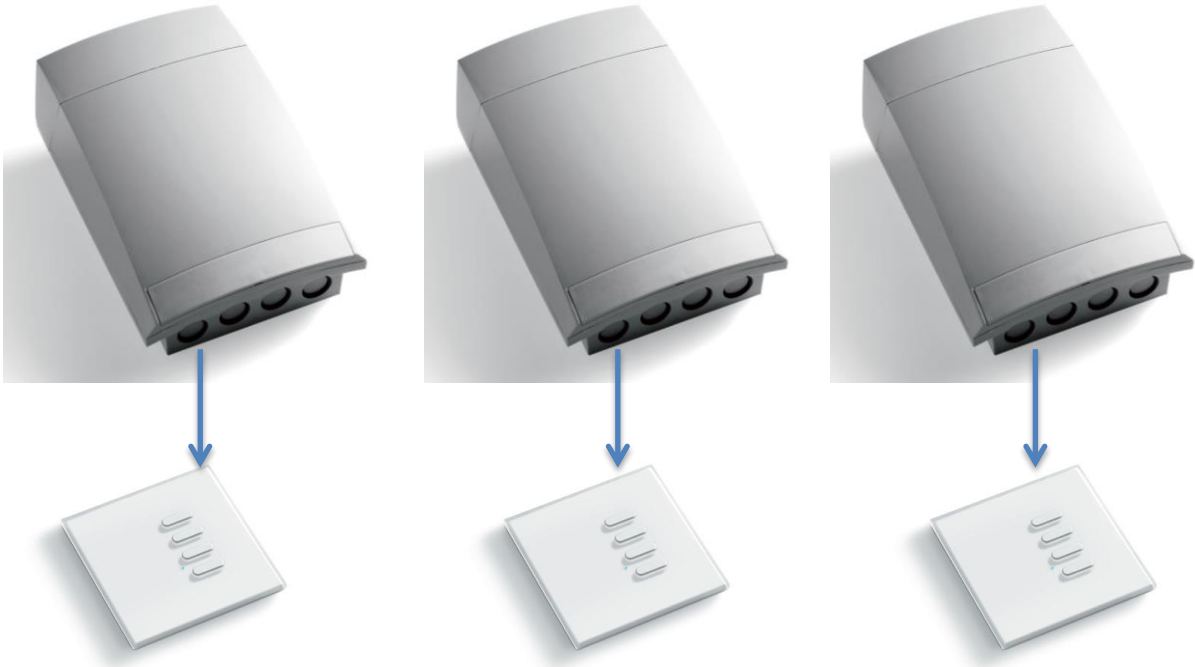

**NOTES:**

- no limit on the amount of receivers a remote can operate
- must be within range of remote to operate (approx. 100ft/30m)